

Mach Basic

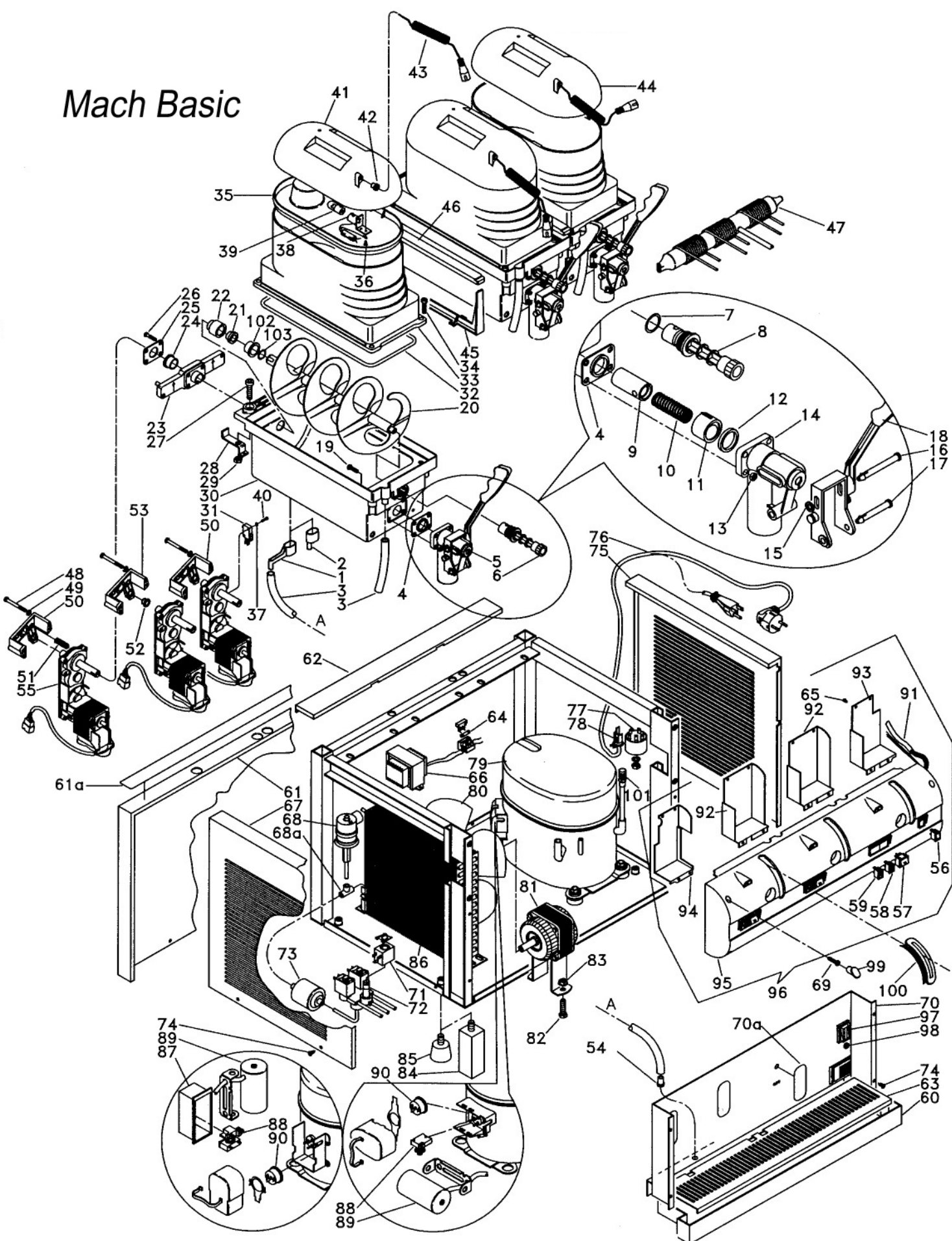

Mach Basic

PART #	DESCRIPTION	BM	M2	M3	MFG #	RETAIL
1	DRAIN PIPE BRACKET	*	*	*	S06.014AGR	2.76
2	DRAIN PIPE SHORT BRACKET	*	*	*	S06.014BGR	2.76
3	DRAIN PIPE	*	*	*	TSC8X11	7.04
4	SPOUT GASKET	*	*	*	G25.4X19X4.76	8.94
5	TAP COMPLETE	*	*	*	ASS.RUBINETTO	113.34
6	COMPLETE SCREW	*	*	*	ASS.POMELLO	12.30
7	O-RING FOR SCREW	*	*	*	OR13000117	0.54
8	PLASTIC SCREW	*	*	*	P1BE020.7GR	11.76
9	SPOUT PLUNGER	*	*	*	P06.012AGR	16.82
10	PISTON SPRING	*	*	*	G0003102-001	2.50
11	SPACING OUTLET	*	*	*	D1BE023.1GR	1.30
12	GASKET DISPENSER	*	*	*	GDI075GACO	6.18
13	NUT	*	*	*	DADOD.5IN	0.66
14	TAP BODY	*	*	*	C1BE023GR	33.08
15	PLASTIC RING	*	*	*	P06.012BC	2.50
16	LONG PIVOT	*	*	*	P06.012BA	5.48
17	PERNO CORTO/SHORT PIVOT	*	*	*	P06.012BB	5.48
18	HANDLE	*	*	*	L06.013GR	27.12
19	SCREW 5X20	*	*	*	VTTC5X16IN	0.66
19	SCREW 5X20	*	*	*	VTTE5X20IN	0.66
20	AUGER	*	*	*	E06.033	195.22
20+111+112	COMPLETE AUGER	*	*	*	ELICAGR	200.64
21	DELRIN PART	*	*	*	B06.031A	2.16
22	MOTOR GASKET	*	*	*	G25/18,2	10.84
21+22	COMPLETE MOTOR GASKET	*	*	*	KITGUARNIZIONE	13.02
23	PLASTIC BUSHING SUPPORT	*	*	*	QUADRCOMPLETO	21.96
24	BRASS BUSHING	*	*	*	B10206125GR	2.82
25	INOX PLATE	*	*	*	P33X27X1.5GR	1.40
26	SCREW 5X20	*	*	*	VTTE5X20IN	0.66
27	SCREW 8X20	*	*	*	VTTCEI8X20Z	0.86
28	PLASTIC TANK LOCK BRACKET	*	*	*	SDIS8405GR	7.48
29	NUT	*	*	*	DADOD.8Z	0.66
30	COMPLETE TANK INSERT	*	*	*	ASS.VASCA.GR	415.38
31	MICROSWITCH I W3 83161118	*	*	*	M51.5701.00	7.60
32	TANK GASKET	*	*	*	G1T960328FBGR	10.30
33	TANK	*	*	*	C06.004GRFB	75.92
34	SCREW 6X12	*	*	*	VTTC6X16IN	0.66
35	LAMP COVER	*	*	*	V06.015FBGR	27.12
36	SCREW 2.9X9.5	*	*	*	VTTC2.9X9.5CR	0.66
37	WASHER 3.2MM	*	*	*	ROND.D.3.2EDENT	0.66
38	LAMP SOCKET	*	*	*	G0005116-001	11.60

Mach Basic

PART #	DESCRIPTION	BM	M2	M3	MFG #	RETAIL
39	LAMP 12V 21W	*	*	*	A0005108-001	15.18
39	LAMP 12V 10W	*	*	*	LAMPADA10W	13.02
40	SCREW	*	*	*	VTTE3X15Z	0.66
41	PLASTIC BLUE COVER	*	*	*	C06.016CGRFB	56.40
42	WIRE LAMP BLOCK	*	*	*	B146600	0.66
43	WIRE LAMP COMPLET	*	*	*	CAVOCUP.LAVORAT	11.94
44	BLUE COMPLETE COVER	*	*	*	ASS.CUPAZZAUTO	99.78
45	PLASTIC CONNECTION	*	*	*	A06.028GR	43.70
46	BLEU COVER	*	*	*	L06.025CELM	4.98
47	ACCUMULATOR BM	*			BOYLERBMCAP	87.84
47	ACCUMULATOR M2		*		BOYLERM2CAP	124.72
47	ACCUMULATOR M3			*	BOYLERM3CAP	162.68
48	SCREW 5X55	*	*	*	VTTE5X55Z	0.66
49	WASHER	*	*	*	ROND.D.5.3EDENT	0.54
50	HOLDER RIGHT	*	*	*	S3087829/1	24.94
51	HARD SPRING	*	*	*	MART.R17	0.66
51	SOFT SPRING	*	*	*	MART.R18	0.66
52	DELRIN PART	*	*	*	B06.031B	4.12
53	HOLDER LEFT	*	*	*	S3087830/1M3	24.94
54	DRAIN PIPE CONNECTION	*	*	*	B06.031C	6.24
55	GEAR MOTOR	*	*	*	M40181209	271.14
55	GEAR MOTOR WITH MICROSWITCH	*	*	*	ASS.MFR110-230V	281.98
56	LAMP SWITCH	*	*	*	IA11114924000	8.36
57	AUGER SWITCH	*	*	*	IA412149C000	12.52
58	COLD SELECTION SWITCH	*	*	*	IA11564929000	14.32
59	FREEZING LIGHT	*	*	*	SA51124G28000	8.94
60	BLUE DRIP TRAY	*			S06.005CBMELM	17.36
60	BLUE DRIP TRAY		*		S06.020CM2ELM	73.76
60	BLUE DRIP TRAY			*	S06.021CM3ELM	107.38
61	BACK PANEL WITH HOLES			*	G0306104-001	87.30
61	BACK PANEL WITH HOLES		*		G0206104-001	74.84
61	BACK PANEL WITH HOLES	*			G0106103-001	62.36
61a	STICKER			*	G0306107-001	4.82
61a	STICKER		*		G0206107-001	3.36
61a	STICKER	*			G0106106-001	2.20
61+61a	BACK PANEL			*	P500001IM3	109.76
61+61a	BACK PANEL		*		P500008IM2	76.94
61+61a	BACK PANEL	*			P500015IBM	72.78
62	TOP METAL COVER M2		*		L500010IM2	15.18
62	TOP METAL COVER BM	*			L500019IBM	12.14
62	TOP METAL COVER M3			*	L50005IM3	17.36

Mach Basic

PART #	DESCRIPTION	BM	M2	M3	MFG #	RETAIL
63	INOX DRIP TRAY			*	G500006IELFAE	33.08
63	INOX DRIP TRAY		*		G500011IELFAE	30.36
63	INOX DRIP TRAY	*			G500020IELFAE	24.94
64	FUSE 2A 5X20	*			F11583	1.08
64	FUSE 5A 5X20	*	*	*	F11584	1.08
65	SCREW	*	*	*	VTTC2.9X6.5CR	0.66
66	TRANSFORMER 100/12V 60VA	*	*	*	A6005101-001	130.14
66	TRANSFORMER 60VA 115V	*	*	*	TZ92602TL60B	130.14
67	STEEL INOX LEFT SIDE PANEL		*	*	P500004IM3/2	82.42
67	STEEL INOX LEFT SIDE PANEL	*			P500018IBM	90.02
68	PRESSURE SWITCH		*	*	A0002101-001	84.60
68	PRESSURE SWITCH	*			A0002101-001	84.60
68a	CUPPER TEE		*	*	TEEDIRAMED6	1.08
68+68a	PRESSURE SWITCH WITH CUPPER TEE		*	*	A0002104-001	85.68
68+68a	PRESSURE SWITCH WITH CUPPER TEE	*			A0002104-001	85.68
69	SCREW 5X16	*	*	*	VTTC5X16CRIN	0.66
70	FRONT PANEL WITH HOLES			*	G0306105-001	87.68
70	FRONT PANEL WITH HOLES		*		G0206105-001	62.36
70	FRONT PANEL WITH HOLES	*			G0106104-001	49.88
70a	STICKER			*	G0006103-001	2.10
70+70a	FRONT PANEL			*	P500002IM3	58.80
70+70a	FRONT PANEL		*		P500009IM2	50.40
70+70a	FRONT PANEL	*			P500016IBM	25.20
71	SOLENOID 115V	*			B304010GR110V	33.62
71	SOLENOID 115V		*	*	BOBWB8,0-110/60	21.70
72	2 WAYS BODY VALVE		*		CPM287ELS	151.84
72	3 WAYS BODY VALVE			*	CPM387ELS	189.80
73	DRYER	*	*	*	FA032SBMM2M3	42.30
74	SCREW 3.9X6.5	*	*	*	VTTC3.9X6.5CR	0.66
75	STEEL INOX RIGHT SIDE PANEL	*			P500003IM3/2	82.42
75	STEEL INOX RIGHT SIDE PANEL		*	*	P500017IBM	90.02
76	SUPPLYING WIRE	*	*	*	C013COD.1373	28.20
76	SUPPLYING WIRE UL	*	*	*	CAVOAL.UL15ALAV	28.20
77	INTERFERENCE FREE FILTER	*	*	*	FFLC560501	34.70
78	CLAMB	*	*	*	M0005112-001	14.10
79	COMPRESSOR		*		C106AD2401AD	683.28
79	COMPRESSOR E2121Z 115V/60Hz	*			C219BG0201AD	336.22
79	COMPRESSOR T2134Z 100V 50/60Hz		*		C237EQ0101AA	683.28
79	COMPRESSOR T2168GK 115V/60Hz		*	*	C906DG2301AE	498.90
79	COMPRESSOR NE2125GK 115V/60Hz	*			C9711G7166AE	623.62
80	ALLUMINIUM BLADE			*	V4012016M3/2	7.80

Mach Basic

PART #	DESCRIPTION	BM	M2	M3	MFG #	RETAIL
80	ALLUMINIUM BLADE	*			V4012201M3WBM	5.42
80	ALLUMINIUM BLADE		*		V4012255	7.60
81	FAN MOTOR	*			A2005101-001	59.66
81	FAN MOTOR	*			M40601950	59.66
81	FAN MOTOR		*	*	M4860059	95.44
82	SCREW 6X12	*			VTTE6X12Z	0.66
82	SCREW 8X16		*	*	VTTE8X16Z	0.66
83	NUT	*			DADOD.6ZFL	0.66
83	NUT		*	*	DADOD.8ZFL	0.66
84	FEET		*	*	A5601101-001	28.20
85	RUBBER FEET	*	*	*	PAR114-ELGR	4.88
86	CONDENSER	*			C04060400100	170.28
86	CONDENSER		*	*	C082036007	171.36
87	BOX	*	*	*	M0005101-001	74.84
88	RELAY NE2125GK 115V/60HZ	*			CLI2283001	49.88
88	RELAY T2168GK 115V/60Hz		*	*	CLI2302005	62.36
88	RELAY E2121Z 115V/60Hz	*			CLICBM115R134	49.88
89	START CAPACITOR T2168GK 115V/60Hz		*	*	COND2252084	62.36
89	START CAPACITOR NE2125GK 115V/60Hz	*			COND2252096	62.36
89	START CAPACITOR E2121Z 115V/60Hz	*			CONDBM115VR134A	62.36
90	THERMAL PROTECTOR T2168GK 115V/60Hz		*	*	TER2297003	37.42
90	THERMAL PROTECTOR NE2125GK 115V/60Hz	*			TER2321004	37.42
90	THERMAL PROTECTOR E2121Z 115V/60Hz	*			TERMBM115VR134A	37.42
91	ELECTRIC WIRING	*			IMPBM	40.56
91	ELECTRIC WIRING		*		IMPM2	52.5
91	ELECTRIC WIRING			*	IMPM3	63.82
92	MIDDLE COVER		*	*	C06.022GR	4.34
93	LEFT COVER	*	*	*	C06.024GR	4.34
94	RIGHT COVER	*	*	*	C06.023GR	4.34
95	BLUE PANEL ABS	*			P06.006CBMELM	67.24
95	BLUE PANEL ABS		*		P06.018CM2ELM	87.84
95	BLUE PANEL ABS			*	P06.019CM3ELM	135.56
96	COMPLETE BLUE PANEL ABS	*			PCBM AZZURRO	57.48
96	COMPLETE BLUE PANEL ABS		*		PCM2AZZURRO	78.64
96	COMPLETE BLUE PANEL ABS			*	PCM3AZZURRO	107.38
97	MAIN SWITCH	*	*	*	I82L2206165	15.18
98	PRESSURE SWITCH LIGHT		*	*	A0005104-001	9.44
98	PRESSURE SWITCH LIGHT		*	*	A0005105-001	9.44
99	SCREW COVER	*	*	*	TAPPOVITEUL	3.58
100	HANDLE COVER	*	*	*	COPRILEVAUL	11.94
101	FREON VALVE CHARGE	*	*	*	VALVSALDARE	25.2

Mach Basic

PART #	DESCRIPTION	BM	M2	M3	MFG #	RETAIL
102	STAINLESS STEEL SLEEVE FOR AUGER	*	*	*	B06.032INOX	4.88
103	O-RING FOR AUGER	*	*	*	G13052056	0.56